

ORGANIZING MAT (depending on the model)

The Organizing Mat is a mat designed to better organize the space on the shelf, and to provide a soft-touch experience when loading heavy items on the shelf. Some slots could also be used to host bottles (horizontally positioned). In order to remove it (for cleaning purpose, or to use it on top of another shelf), first remove the shelf where it is currently placed. The mat is dishwasherable.

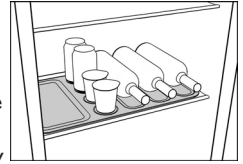

NET SHELF (depending on the model)

The Net Shelf is the net which can be used to store little items directly under the glass shelf, taking full advantage of this space. Pull down the net shelf (using the lip on the front) to load/unload it.

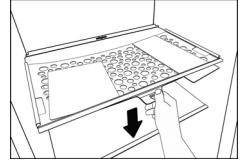

The net is flexible: do not stress it by loading it with bulky or heavy items. Maximum weight allowed: 2 kg. To remove the net (for cleaning purpose, or to use it under another shelf), you have to first remove the glass shelf under which the net is currently placed. The net shelf is dishwasherable.

HOW TO START THE APPLIANCE

Fit the spacers (if supplied) on the upper part of the condenser at the rear of the appliance.

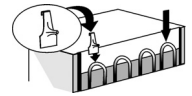

After plugging the appliance to the mains, it starts the operation automatically.

After starting the appliance, wait at least 4-6 hours before placing food into the appliance.

Note:

- If food is placed in the refrigerator before the appliance has cooled completely, it may deteriorate.

ECO GREEN FUNCTION (depending on the model)

This function gives best food preservation performance with the smallest energy consumption possible (around 5-10% less in comparison with the normal settings) if there is lower amount of food to be preserved in the appliance.

The best food preservation conditions when ECO function is activated are in the ECO compartments:

- - 2 "eco green" shelves in the fridge (with green frames)

- 1 "eco green" basket in freezer compartment

To select the function turn the ECO symbol on the knob of the regulator.

A. Refrigerator Compartment

1. Filter in fan
2. Thermostat / light unit
3. Shelves / Shelf area
4. Cooler compartment (best for meat and fish)
5. Rating plate with commercial name
6. Fruits and vegetables crisper
7. Crisper divider
8. Reversibility kit
9. Egg tray
10. Separator
11. Door trays

B. Freezer Compartment

12. Storage zones for frozen food items (basket or flap)
- 12a. "Eco green" basket (only in models with ECO GREEN function)
13. Ice tray and/or cold accumulator
14. Bottom basket (freezing zone)
15. Door seals
16. The freezer door trays for pizza or other frozen food with a short storage time (2** storage compartment).

Anti-bacterial protection (depending on the model):

- Antibacterial filter in the fan (1)
- Antibacterial additives in the Crisper (6)
- Door seals are made of material able to inhibit bacterial growth (15).

Freezer using:

- The freezer compartment can be used without the baskets / flap to increase storage and for large food. Place the food directly on the racks.
- The bottom basket is specific compartment for freezing large food. After inserting food, ensure that the freezer compartment door closes properly.

Notes:

- **Depending on the model** the number and type of accessories may vary.
- In case of power failure the cold accumulator helps to keep optimal storage temperature longer.
- All shelves and door trays are removable.
- The internal temperatures of the appliance depend on the ambient temperature, frequency of opening the doors, as well as location of the appliance. Temperature setting must consider these factors.
- The appliance accessories are not suitable for washing in dishwasher.

FAN (depending on the model)

The fan improves temperature distribution inside the refrigerator compartment, allowing better preservation of stored food

Important:

Do not obstruct the air intake area with food items. The fan will run ONLY when the compressor is in operation.

Fan with a button

To switch on or switch off the fan press the button (1a). It is advisable to activate the fan when the ambient air temperature is over 27 ÷ 28°C or if you perceive drops of water on the glass shelves or in the severe humidity conditions.

Fan switched on improves cooling conditions. To keep preferable appliances setting, having the fan switched on, there may be a need to adjust the thermostat. If fridge is too cold the fan can be switched off.

Important:

Remember to turn off the fan when there is a lower ambient air temperature.

Fan without a button

An electric system automatically turn on and turn off the fan.

If the appliance has the fan it can be equipped with the filter.

Remove it from the box (found in the crisper drawer (item 6) and insert into the cover of fan (item 1b).

The replacement procedure is attached with the filter.

FRIDGE/FREEZER COMPARTMENT CONTROLS

- A. Thermostat knob
- B. Light button
- C. Thermostat setting indicator
- D. Light bulb ((max power the light bulb is given on the light cover)

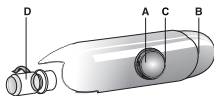

The thermostat adjusts temperature in both compartments.

Thermostat set to **1/MIN: low cooling intensity**

Thermostat set between **1/MIN and 7/MAX** : cooling intensity can be adjusted according to the preferences.

Thermostat set to **7/MAX: maximum refrigeration intensity.**

For the best food conservation **3-5/ MED** position is recommended.

Thermostat set to **•** : **cooling and lighting off.**

Thermostat set to **ECO GREEN** : **ECO function active.**

FREEZING FRESH FOOD

Place the fresh food to be frozen into the bottom basket. Avoid direct contact with already frozen food.

To freeze the quantity of food shown on the rating plate, rotate the thermostat knob towards a slightly warmer position just before fresh food insertion (for example, in case of numbers, if chosen set value is 4 move it back to 3,5).

After 24 hours the food will be frozen. Move back the thermostat knob to the previous position.

REPLACING THE LIGHT BULB

Before replacing the bulb, remove the power plug from the mains socket.

To remove the light bulb turn anticlockwise as shown in figure .

DEFROSTING THE FREEZER COMPARTMENT

The freezer should be defrosted once or twice a year or when excessive frost is present (3 mm thickness).

The formation of frost is normal.

The amount and rate at which frost accumulates depends on room conditions and how often the door is open.

To defrost the unit, switch off the freezer compartment or the whole appliance, depending on the model, and remove all food products.

Leave the freezer door open to allow the frost to melt. For appliances in figure only pull out the defrost water drain and place a container under the drain.

When the operation is completed, put back the defrost water drain.

Clean the inside of the freezer. Rinse and dry thoroughly. Switch the freezer compartment, or the whole appliance, back on and store the food inside.



DEFROSTING THE REFRIGERATOR

Refrigerator compartment defrosting is completely automatic.

Droplets of water on the rear wall inside the refrigerator compartment indicate that the automatic defrost phase is in progress. The defrost water is automatically run into a drain hole and collected in a container, where it evaporates.