

# USING THE REFRIGERATOR COMPARTMENT

## Switching the appliance on

### Starting the appliance

Insert the plug.

- The light, located under the control panel or inside the product (depending on model) comes on when the door is opened.
- The green light comes on, indicating that the appliance is working (if present).

### Note:

For mechanical products, the inside light comes on when the fridge door is opened if the thermostat knob is not turned to the symbol ●.

### Adjusting the temperature

- For temperature adjustment, see the enclosed product sheet

### Note:

- Ambient air temperature, frequency of door opening and the position of the appliance can affect internal temperatures. The temperature setting must be adjusted according to these factors.

### Storing food the refrigerator compartment

Place the food as shown in the figure.

**A** Cooked food

**B** Fish, meat

**C** Fruit & vegetables

**D** Bottles

**E** Cheese

### Notes:

- The distance between the shelves and the rear wall inside the refrigerator ensures the free circulation of air.
- Do not place food in direct contact with the rear wall of the refrigerator compartment.
- Do not place hot food in the refrigerator.
- Store liquids in closed containers.

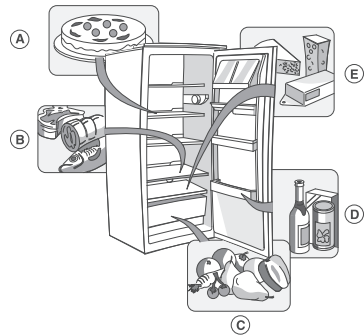

### Attention

**Storing vegetables with high water content can cause condensation to form on the glass shelf of the crisper drawer: this will not affect the correct operation of the appliance.**

### Gourmet box (if present)

Box with natural antibacterial substances suitable for contact with food products; they ensure better hygiene, reducing unpleasant odours and keep ripe cheeses and charcuterie fresh longer.

### "6th Sense" function

The 6th Sense function (if present) is automatically activated in the following case:

#### Door opening

The function is activated whenever door opening considerably alters the temperature inside the product and remains active until optimum storage conditions are automatically reinstated.

**NOTE:** The duration of the 6th Sense function is calculated according to the amount of food present in the product and the outside temperature. Therefore significant variations in these can affect the behaviour of the product.

### "Fresh Control" function (if present)

Enables optimum storage temperature and humidity conditions to be quickly reached inside the appliance.

# HOW TO OPERATE THE LOW TEMPERATURE COMPARTMENT

The low temperature compartment is **\*\*\***, **\*\*** or **\***.

Compartments marked **\*\*** or **\*\*\*** can be used to store frozen foods for the period of time indicated on packaging. If the low temperature compartment is marked **\***, it can also be used to freeze fresh food.

The quantity of fresh food that can be frozen in 24 hours is shown on the rating plate.

**Note:**

In the event of a power cut, the low temperature compartment will maintain a sufficiently low temperature for food storage. However, it is advisable to avoid opening the compartment door during such periods.

**Freezing fresh food (only in compartments marked **\***)**  
**Important**

- Before freezing, wrap and seal fresh food in: aluminium foil, cling film, air and water-tight plastic bags, polythene containers with lids or freezer containers suitable for freezing fresh food.
- Arrange the fresh food in the top compartment, leaving sufficient space around each pack for the air to circulate.
- For optimum freezing, turn the thermostat down by half a point when placing fresh foods in the freezer compartment.
- The food will be completely frozen in 24 hours.



**For appliances with compartments marked **\*****  
**The table alongside shows the recommended maximum storage time for frozen fresh foods.**

**When purchasing frozen food products:**

- Make sure the packaging is not damaged, since the product quality may have deteriorated. If a package is swollen or has damp stains it has not been perfectly conserved and may started thawing.
- When shopping, leave frozen food purchases until last and transport the products in a thermally insulated cool bag.
- Place the items in the low temperature compartment as soon as you get home.
- If food has defrosted even partially, do not re-freeze it. Consume within 24 hours.
- Avoid, or keep temperature variations to the minimum. Respect the best-before date on the package.
- Always observe the storage information on the package.

MONTHS	FOOD
1-3	
4-7	
8-12	

**Making ice cubes**

- Fill the ice cube tray 2/3 full and place it in the low temperature compartment.
- Do not use sharp or pointed instruments to detach the tray if it is stuck to the low temperature compartment bottom.
- Bend the ice tray slightly to remove the cubes.

# HOW TO DEFROST AND CLEAN THE REFRIGERATOR

**Before any cleaning or maintenance operation, unplug the appliance from the mains or disconnect the electrical power supply.**

**Defrosting of the refrigerator compartment is completely automatic.**

Droplets of water on the rear wall of the refrigerator compartment indicate that the periodic automatic defrost cycle is in progress.

The defrost water is automatically routed to a drain outlet and into a container from which it evaporates.

Clean the defrost water drain outlet regularly using the tool supplied with the appliance in order to ensure defrost water is removed correctly.

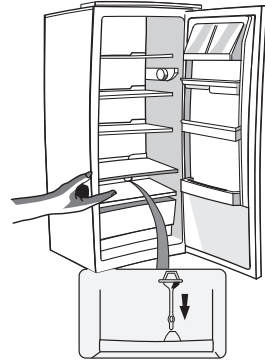

## **Defrosting the low temperature compartment**

**Defrost the low temperature compartment once or twice a year or when the ice formation is excessive. It is perfectly normal for ice to form. The amount of ice which forms and the rate at which it accumulates will depend on room temperature and humidity, and on the frequency with which the door is opened. Ice formation is concentrated at the top of the compartment and does not affect the efficiency of the appliance.**

**If possible, carry out defrosting when the compartment is nearly empty.**

- Remove the food from the low temperature compartment, wrap in a newspaper and group together in a cool place or in a portable cooler.
- Leave the door open to allow the frost to melt.
- Clean the interior with a sponge soaked in warm water and/or neutral detergent. Do not use abrasive substances.
- Rinse the interior and dry thoroughly.
- Put the food back into the compartment.
- Close the door.
- Plug in the appliance once again.
- Switch the appliance on.

# CLEANING AND MAINTENANCE

**Before any cleaning or maintenance operation, always unplug the appliance or disconnect it from the power supply.**

- Clean the inside of the refrigerator compartment regularly with a sponge dampened in warm water and/or neutral detergent. Rinse and dry with a soft cloth. Do not use abrasive products.
- The separators must not be washed with water but cleaned with a lightly dampened sponge.
- Clean the inside of the freezer compartment when defrosting.
- Clean the air vents and condenser at the rear of the appliance regularly with a vacuum cleaner or brush.
- Clean the outside with a soft damp cloth. Do not use abrasive products, scourers, stain-removers (e.g. trichlorethylene acetone) or vinegar.

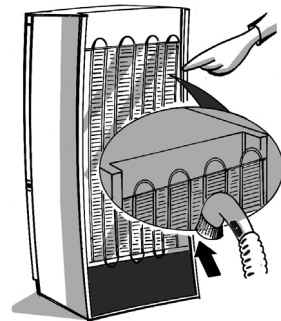

## **For long vacations**

1. Empty the refrigerator.
2. Disconnect the appliance from the mains power supply.
3. Defrost and clean the interior.
4. In the event of prolonged disuse, leave the door open to prevent mould, odours and oxidation from forming.
5. Clean the appliance.
  - Clean the inside of the low temperature compartment (where fitted) when defrosting.
  - Clean the inside of the refrigerator compartment regularly with a sponge dampened in warm water and/or neutral detergent. Rinse and dry with a soft cloth. Do not use abrasive products.

# TROUBLESHOOTING GUIDE

When you hear these noises

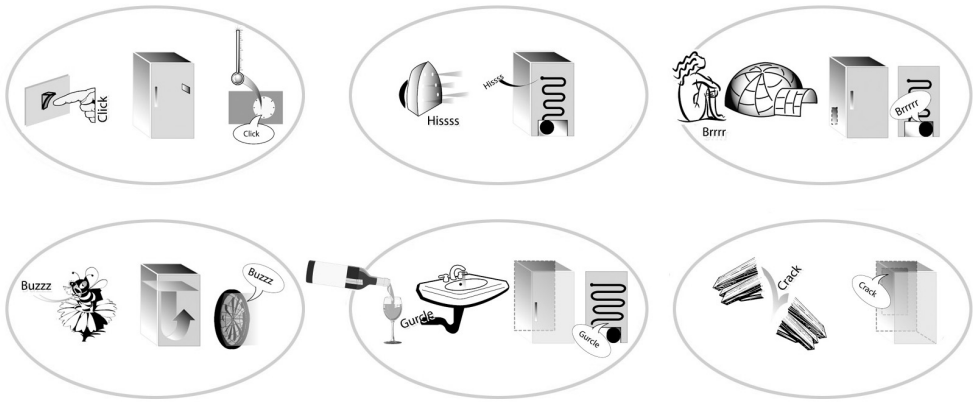

**..your appliance is alive!!!**

## **1. The appliance doesn't work.**

- Is there a power failure?
- Is the plug properly inserted in the socket?
- Is the double-pole mains switch on?
- Do the household electrical system protection devices work properly?
- Is the power cord damaged?

## **2. The temperature inside the compartments is not low enough.**

- Are the doors closed properly?
- Is the appliance installed near a heat source?
- Are the air circulation vents obstructed?

## **3. There is water on the bottom of the refrigerator compartment.**

- Is the defrost water drain is obstructed?

## **4. The inside light doesn't work.**

Check point 1, then:

- Disconnect the appliance from the power supply.
- If your product has a lamp, to check and replace it see the instructions and figure on the attached sheet
- If your appliance has LED lights, contact the after-sales service.

## **5. Excessive frost in the freezer compartment.**

- Is the door closed properly?
- Is food obstructing door closing?

**Gurgling and hissing noises due to expansion in the refrigerant circuit are normal.**

# AFTER SALES SERVICE

## Before contacting the After-Sales Service:

1. See if you can solve the problem yourself with the help of the "Troubleshooting guide".
2. Switch the appliance on again to see if the problem has been solved. If it has not, switch off the appliance again and repeat the operation after one hour.
3. If the malfunction persists, call After-Sales Service.

## Specify:

- the type of fault.
- the model.
- the Service number (the number after the word SERVICE on the rating plate inside the appliance).

- your full address
- your telephone number and area code.

**SERVICE** 0000 000 00000



## Note:

**If reversing of appliance door opening is carried out by the After-sales Service it is not covered by the warranty.**

# INSTALLATION

- Install the appliance away from heat sources. Installation in a hot place, near heat sources (radiators, cookers) or direct exposure to the sun will increase energy consumption and should be avoided.
- If this is not possible, respect these minimum distances:
  - 30 cm from coal or oil stoves;
  - 3 cm from electric and/or gas cookers.
- For optimum operation, ensure:
  - a space of at least 5 cm above the appliance;
  - a distance of at least 4 cm from the rear wall;
  - place other cabinets at a suitable distance from the appliance to allow at least some air circulation
- Install the appliance level (adjust the front feet if necessary) in a dry and well-aired place.
- Clean the inside.
- Insert the accessories supplied.

## Electrical connection

- **The electrical connections must comply with the local regulations.**
- Voltage and power input are specified on the rating plate inside the appliance.
- **Regulations require the appliance to be earthed. The manufacturer declines any liability for injury or damage resulting from failure to observe the above rules.**
- If the plug and socket are not of the same type, have the socket replaced by a qualified technician.
- Do not use extension leads or multi-adapters.

## Electrical disconnection

It must be possible to electrically disconnect the appliance by unplugging it or by means of a double-pole switch installed ahead of the socket.